

Nyloc Insert Nut

Thread Type: Metric - Fine

Thread Direction: Right Hand

Material: Carbon Steel

Class Grade: High Tensile Class 8

Finish: Zinc Yellow

Corrosion Protection Level: Moderate

Standard: DIN 985

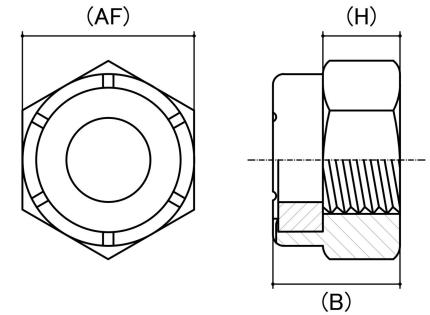

*CAD drawings shown for graphic representation only.**

Size	Thread Pitch (mm)	Thread Type	Overall Nut Height (B) (mm)		Hex Height (H) (mm)	Across Flats (AF) (mm)		Spanner Size (AF) (mm)	sku (qfind)
			Min	Max	Nom	Min	Max		
M8	1.00	Fine	7.64	8.00	5.50	12.73	13.00	13	41NMF8100ZY
M10	1.25	Fine	9.64	10.00	6.50	16.73	17.00	17	41NMF10125ZY
M10	1.00	Fine	9.64	10.00	6.50	16.73	17.00	17	41NMF10100ZY
M12	1.50	Fine	11.57	12.00	8.00	18.67	19.00	19	41NMF12150ZY
M12	1.25	Fine	11.57	12.00	8.00	18.67	19.00	19	41NMF12125ZY
M16	1.50	Fine	15.30	16.00	10.50	23.67	24.00	24	41NMF16150ZY
M20	1.50	Fine	18.67	20.00	14.00	29.16	30.00	30	41NMF20150ZY

Disclaimer:

Dimensional data and technical information was obtained from publically available sources and not acquired through standard agencies. It has been completed and compiled for reference purposes only; where discrepancies are found they are subject to change without notice. Bolt & Nut Australia makes no warranties or representations regarding the accuracy and validity of the compiled information and data. Contact the relevant standard authorities for accurate and detailed information.

* CAD drawings may not reflect diameter, thread length or overall length.

© Bolt & Nut Australia Pty Ltd. All rights reserved.

Version: 18 Mar 2024